

Front view and mounting

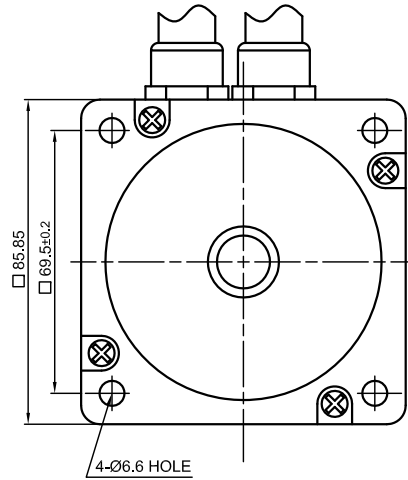

Side view

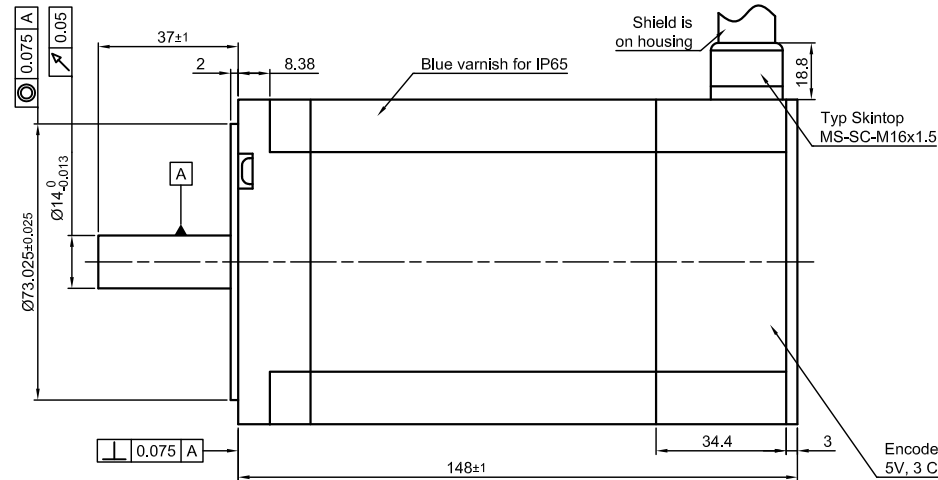

Rear view

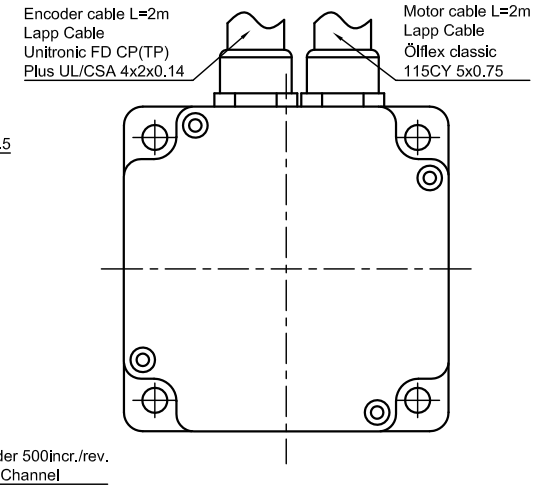

CONNECTION		BIPOLAR PARALLEL	PERMISSIBLE RADIAL+AXIAL FORCE				M16 MOTOR		M16 ENCODER		
SPECIFICATION							CABLE NO.	ASSIGNMENT	COLOR	ASSIGNMENT	
VOLTAGE (VDC)		2.18	ROTOR SPRING-MOUNTED IN AXIAL DIRECTION SPRING WASHER BEARING				1	A	WHT	A	
AMPS/PHASE		9.5	AXIAL-FORCE F_a (N)				2	A\	BRN	A\	
RESISTANCE/PHASE (Ohms)@25°C		0.23±15%	$F_a=65$				3	B	GRN	B	
INDUCTANCE/PHASE (mH) @1KHz		2.7±20%	DISTANCE a (mm)				4	B\	YEL	B\	
HOLDING TORQUE (Nm) [lb-in]		9.33 [82.57]	RADIAL-FORCE F_r (N)				5	HOUSING	GRY	GND	
DETENT TORQUE (Nm) [lb-in]		0.2 [1.7]	AXIAL						PINK	I	
STEP ANGLE (°) ± STEP ACCURACY		1.8 ± 5% (NON-ACCUM)	RADIAL						BLU	I\	
BACK-EMF (V) (300 U/min)		23.15	SHAFT PLAY (mm)						RED	Vcc	
ROTOR INERTIA (Kg-m ²) [lb-in ²]		3.0x10 ⁻⁴ [1.025]	AT LOAD MAX: (N)								
WEIGHT (Kg) [lb]		3.95 [8.71]	10								
TEMPERATURE RISE: MAX.80°C (MOTOR STANDSTILL; FOR 2 PHASE ENERGIZED)			5.0								
AMBIENT TEMPERATURE -10°~ 50°C [14°F ~ 122°F]			10								
INSULATION RESISTANCE 100 MOhm (UNDER NORMAL TEMPERATURE AND HUMIDITY)			10								
INSULATION CLASS B 130° [266°F]			10								
DIELECTRIC STRENGTH 500VAC FOR 1 MIN. (BETWEEN THE MOTOR COILS AND THE MOTOR CASE)			10								
AMBIENT HUMIDITY MAX. 85% (NO CONDENSATION)			10								
			10								
			10								
			10								
REV	DESCRIPTION	DATE	APVD			SCALE FREE	APVD	S.Ha.	13.11.08	STEPPING MOTOR	
				AP8918L9504-E		X ±0.5	CHKD			DWG.NO	
				AP8918L9504-E		1PL ±0.2	DRN	J.W.	13.11.08	AP8918L9504-E	
				AP8918L9504-E		2PL ±0.1	SIGNATURE		DATE	AP8918L9504-E	
				AP8918L9504-E		ANGLE ±30'				AP8918L9504-E	