

Front view and mounting

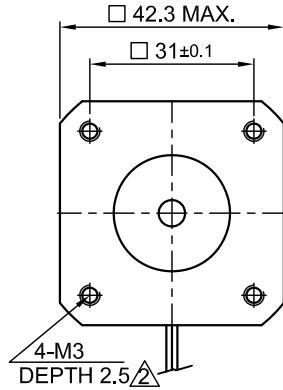

Side view

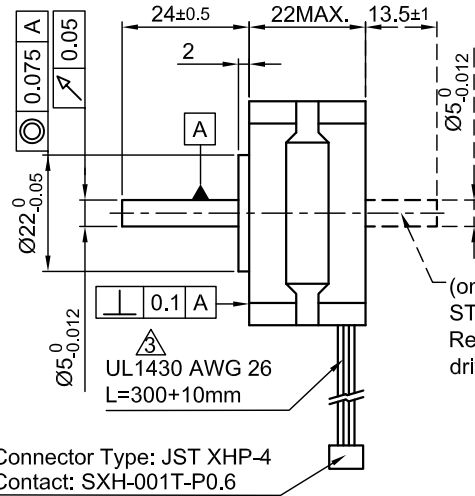

Rear view

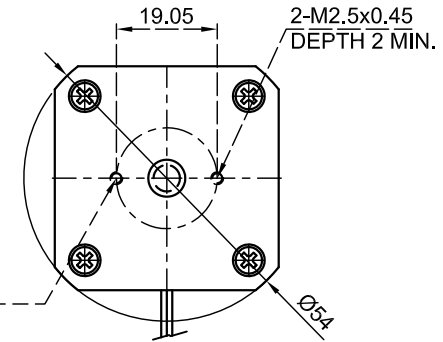

Connector Type: JST XHP-4
Contact: SXH-001T-P0.6

CONNECTION	BIPOLAR
SPECIFICATION	
VOLTAGE (VDC)	8.7
AMPS/PHASE	1.0
RESISTANCE/PHASE (Ohms)@25°C	8.7±15%
INDUCTANCE/PHASE (mH) @1KHz	18±20%
HOLDING TORQUE (Nm) [lb-in]	0.17 [1.505]
DETENT TORQUE (Nm) [lb-in]	3.0x10 ⁻³ [0.0266]
STEP ANGLE (°)	0.9
STEP ACCURACY (NON-ACCUM)	±5%
ROTOR INERTIA (Kg-m ²) [lb-in ²]	2.0x10 ⁻⁶ [6.8x10 ⁻³]
WEIGHT (Kg) [lb]	0.15 [0.331]

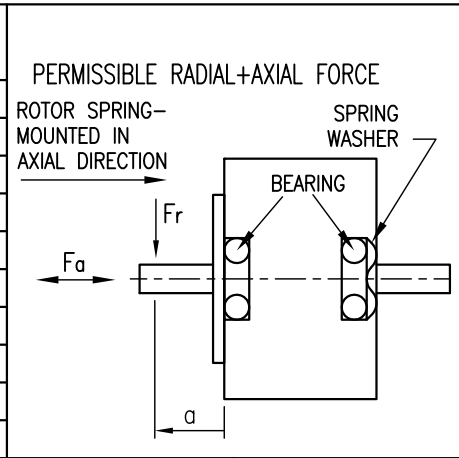

TYPE OF CONNECTION (EXTERN)	MOTOR		
	CONNECTOR PIN NO.	LEADS	WINDING
BIPOLAR			
A —	1	BRN	A
A\ —	2	ORG	A\
B —	3	RED	B
B\ —	4	YEL	B\

TEMPERATURE RISE: MAX.80°C (MOTOR STANDSTILL; FOR 2 PHASE ENERGIZED)	AXIAL-FORCE Fa (N)	Fa=7
AMBIENT TEMPERATURE -10~ 50°C [14°F ~ 122°F]	DISTANCE a (mm)	5 10 15 20
INSULATION RESISTANCE 100 MOhm (UNDER NORMAL TEMPERATURE AND HUMIDITY)	RADIAL-FORCE Fr (N)	58 36 26 20
INSULATION CLASS B 130° [266°F]		AXIAL RADIAL
DIELECTRIC STRENGTH 500VAC FOR 1 MIN. (BETWEEN THE MOTOR COILS AND THE MOTOR CASE)	SHAFT PLAY (mm)	0.075 0.025
AMBIENT HUMIDITY MAX. 85% (NO CONDENSATION)	AT LOAD MAX: (N)	10 5.0

FULL STEP 2 PHASE-Ex.,
WHEN FACING MOUNTING END (X)

STEP	A	B	A\	B\	CCW	CW
1	+	+	-	-	↓	↑
2	-	+	+	-	↑	↓
3	-	-	+	+	↓	↑
4	+	-	-	+	↑	↓

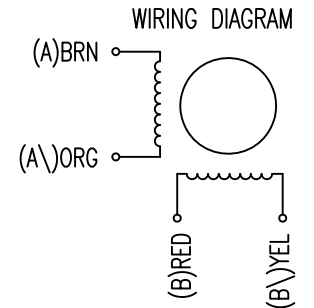

3	INDUCTANCE + UL NO.	01.07.09	J.W.
2	SCREW THREAD DEPTH	30.01.07	J.W.
1	HOLDING TORQUE	08.01.07	J.W.
REV	DESCRIPTION	DATE	APVD



ST4209X1004

SCALE FREE	APVD	S.Hα	15.12.06
X ±0.5	CHKD		
1PL ±0.2	DRN	J.W.	29.06.06
2PL ±0.1	SIGNATURE		
ANGLE ±30'	DATE		

STEPPING MOTOR

DWG.NO
ST4209X1004